

# MULTIFUNCTION ELECTRIC GRINDER

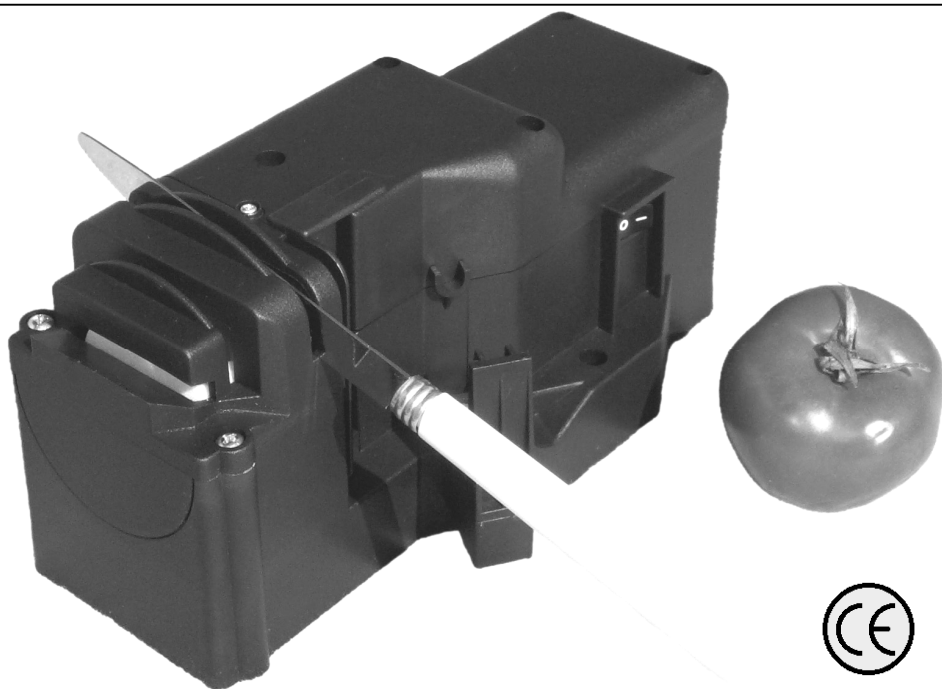

**Made in Italy**

## MANUAL INSTRUCTION

The builder reserves all the laws on the present manual that could not be reproduced, also partially, without written authorization. The builder reserves the law of modify manual dictum in each his part or contained, without warning

## ATTENTION!

Carefully observe the instructions given in this manual to ensure safe operations and good results. Before starting any work, check this manual with care and refer to it for important details or when you do maintenance. You can find a spare Ref. Number in the exploded drawing at the back of this manual. Do not remove the sticker with all the engine technical specification from the Grinder. All the work not mentioned in this manual must be done by an authorised repair shop. Use only original replacement parts to assure optimum performance and safety.

**Attention: Always wear protective goggles when connecting to power supplies and using the machine.**



## SPECIFICATIONS

Machine: Multifunction Electric Grinder

Models: (unique) 220 Vac - 50 Hz - 300 W

Grinding wheel dimensions: Ø est. 60,0 mm (2,34"); Ø int. 10,0 mm (0,389"); thickness: 9,0 mm. (0,351")

Grinding wheel dimensions: Ø est. 45,0 mm (1,75"); Ø int. 10,0 mm (0,389"); thickness: 9,0 mm. (0,351")

**Attention: use original grinds guaranteed only up to 5.600 rpm.**

Maximum speed: 5.000 rpm

Sound pressure level: 84,0 / 111 L<sub>PA</sub>/ L<sub>WA</sub> (dB(A))

Level of Vibration transmitted to the handle: 7,9 a<sub>w</sub> (m/s<sup>2</sup>)

Weight of complete machine: 1,34 Kg (2,95 pounds)

## WARRANTY

The Multifunction Electric Grinder is guaranteed against faulty materials and workmanship for 24 months from the date of purchase shown on the bill of parcel, invoice or receipt (to be shown at the time of reparation). The guarantee covers the parts that will come exclusively compare defective to the origin and it doesn't cover damages caused from the conveyor third or atmospheric or environmental causes (lightnings, etc.)

The guarantee will be invalidated if:

1. The electric grinder is tampered with.
2. The electric grinder is not used as described in this manual.
3. Non-original and/or unauthorised parts, tools or grinding wheels are mounted on the machine.
4. The electric grinder is connected to power supplies with different specifications to those shown on the sticker.

## SECURITY



The machine must be used exclusively by adults that:

- 1.) He has read the operating procedures and safety rules.
- 2.) Avoid any wrong positioning. Never allow children to operate the machine. Do not allow adults to operate it without proper instruction.
- 3.) The electric grinder must be only used by persons in good health who fully understand the usage.
- 4.) Before starting the machine, always wear safety goggles.
- 5.) Do not remove, damage or otherwise render ineffectual the safety device; or the grinding wheel guard, never modify any part of the machine.
- 6.) Do all the machine setup procedure, the grinding wheel assembling and disassembling when the machine is switched off and the plug is removed from the power socket.
- 7.) Always use electric cables, plugs and sockets in good conditions and within specification. The electrical connection must be made in such a way as to prevent people or other machines from damaging it and causing a dangerous situation.
- 8.) If the connecting cable is damaged do not switch on the machine. Remove the plug form the power socket with extreme caution. For repairs or replacements contact your dealer or authorised service centre.
- 9.) Make sure that the feeding cable is far from the grinding area. Do not perform grinding operations near other power cables.
- 10.) Place the grinder on the workbench in a comfortable position for the operator. The working area must be free of tools and other objects, and for from any flammable materials. During grinding the grinding wheel generates sparks which could cause fires or explosions.
- 11.) Do not place the grinder at the operator eye level:  for an easier and safer grinding procedure the machine must be below the eye level.
- 12.) Always keep the grinder and especially the handgrip clean and dry.
- 13.) Before starting grinding operations, take away all the unnecessary people around your working area, who do not wear safety goggles, and do not know the use of the grinder.
- 14.) Follow the instructions given for maintenance. never work with a damaged grinder.
- 15.) During grinding procedure, always hold the handgrip.

## WARNING ABOUT THE GRINDING WHEEL

1. Only use grinding wheels as mentioned at point "SPECIFICATIONS". Never force a grinding wheel onto the machine or change the diameter of the mounting hole.
2. If the grinding wheels are installed in too shut way they could break during the employment. To avoid this risk, tighten the screw manually with care.
3. Once the grinding wheel is mounted, refit the grinding wheel guard before switching on the machine.
4. Always test grinding wheel for at least a minute at operating speed before carrying out grinding. During this operation, keep away from the wheel and make sure no one else is standing in line of the wheel rotation trajectory
5. If the grinding wheel is found to vibrate when starting up or operating the machine, stop it immediately cutting the power off. Check that the grinding wheel is fitted correctly and that the grinding wheel is not damaged. Before grinding again repeat the above test.

**Attention!** Never try to stop the grinding wheel with your hand, even if you wear safety gloves. Touching the grinding wheel when it is turning at high speed can cause burs and abrasions! 

The grinding wheels of exchange they have to be conforming to those defined in the chapter "SPECIFICATIONS" and however to the rules in vigor and following integrations and changes (DPR 547/55, L.320/90, Technical Education ENPI n°63/19 of 01/01/1972).



## RESIDUAL RISK

- 1) Place and store the grinder in a dry place, and avoid contact with the ground. Do not expose it to rain; do not use it in place where the air can be impregnated with flammable or explosive gas or liquid.
- 2) Do not wear bracelets, other jewellery or loose-fitting clothing; it is liable to come into contact with the grinding wheel and grinding area.
- 3) Do not use extension cables that are defective and/or do not meet applicable standards.
- 4) During the grinding wheel and the motor operating test, verify that the machine stops when you press the "O" switch. If this does not happen contact your dealer or authorised service centre.
- 5) For grater sensitivity of touch, it is not obligatory to wear gloves.
- 6) **Attention!** the machine has been designed exclusively to sharpen knives, scissors and drill bit. Any improper use is forbidden, do not use other tools than grinding wheels, do not grind and/or cut other objects!
- 7) Do not use the machine when you are tired.
- 8) The machine must not be used at different voltages from the ones specified on the sticker on the machine.
- 9) Contact your dealer for repair and/or replacement of defective or worn machine parts not describe in this manual.

## TRANSPORT

The machine is supplied in a recyclable cardboard box. The box must be handled with care and must not be knocked while being moved.

## MAINTENANCE

1. **Attention!** All the operations of maintenance to be done only with electrical power supply disconnected! 
2. The machine must be kept clean so the technical data stickers and the scales are clearly visible. For cleaning DO NOT use compressed air, use a rag or brush for cleaning.
3. Replace the grinding wheel when it has reached a diameter lower than 5 mm (0.19")
4. For repairs or replacements contact your dealer or authorised service centre.
5. Use only OEM spare parts. 

## SCRAPPING

The electric grinder is made of up to 95% recyclable materials. Even the cardboard box is recyclable. Do NOT discard them in the environment. If you decide to permanently stop the use of the grinder, we kindly ask you to place the scraps in the dedicated containers.

## INSTALLATION

- a) Assemble the machine as shown in Fig. 1.
- b) Verify that the workbench, where the grinder will be fixed, applies to the specifications mentioned in point "SAFETY" and "RESIDUAL RISK". Install the grinder with nuts and bolts (which are not supplied) in proportion to the thickness of your bench. Check the fastening strength before the use.

**Attention!** All adjustment must be made with the machine turned off and with the electrical power supply disconnected. 

## GRINDING

**Attention!** For avoid of damage of the tools don't force the sharpening too removing only least quantity of material and don't stay too on the same point. 

**Attention!** Always wear protective goggles during all the grinding procedure.



### Sharpening of Knives

N.B. You correct sharpening of a knife depends on the same knife, a knife will very often require past on the grindstones in comparison to a thin knife.

1. Turn on the grinder.
2. Grasp the knife from the handle, to insert the blade in the special crack: "great central guide" for great blades or "small central guide" for small blades (Fig. 2)
3. Support the knife to the couple of massive structure abrasive in the nearest part to the handle and, without pressing too much, to throw the knife toward of it so that the abrasive grindstones acts on the whole length of the blade. (Fig. 3)
4. Repeat the operations of the point (3) up to when the knife has not perfectly sharpened.

### Sharpening of the Scissors

The scissors unlike the knives have an only sharpening in the inside part and therefore they never have to be sharp in the 2 "central guides". The scissors have to be sharp from one side at a time and they are sharpened in the part "external side guide" of the grindstones. The "lateral side guide" it has the correct angle of inclination to sharpen all the types of scissors.(Fig.2)

N.B. The correct sharpening of the scissors depends above all from as they are sharpened: norm is good to make the same number of trails for every side of the scissors so that results sharp in equal way.

1. Turn on the grinder.
2. Open the scissors, to grasp only her from a side and to insert her in the special one "side guide."
3. Support the scissors to the side grindstones in the nearest part to the hilt and, without pressing too much, to throw the scissors toward of it so that the abrasive grindstones acts on the whole length of the blade. (Fig. 4)
4. Perform then 2/3 trails for blade to change hilt and to perform other 2/3 trails, as to the point (3), for the other hilt.

### Sharpening of the Drill Bit

Remove the drill bit guard before every sharpening and to put again it after the sharpening (Fig. 5). The drill points have to be sharp using the special one "block brings drill bit" and sharpening the drill bit in the part "side inside" of the grindstones.

N.B. As for the scissors the correct sharpening of the drill bits depends above all from as they are sharpened: norm is good to make the same number of trails for every side of the drill bit so that results sharp in equal way.

#### *Assemblage of the Drill Bit*

1. Climb on the "block brings drill bit"
2. Insert the drill bit in the "block brings drill bit" (not to shut the grapevines!), to insert the all in the guide of sharpening and to approach the drill bit up to touch the grindstones to establish the correct length of the drill bit (Fig.6).
3. Extract the "block brings drill bit" from the guide and to rotate the drill bit as from (Fig.7) and to shut the 2 grapevines of the "block brings drill bit".

#### *Sharpening of the drill bit*

1. Insert the "block brings drill bit" in the guide of sharpening and to effect downward 2/3 trails from the tall one for a side of the drill bit. (Fig. 8)
2. Extract the " block brings drill bit ", to rotate it of 180° and to repeat the operations of the point (1) for the other side of the point.

## GRINDING WHEELS CHANGE

**Attention!** All adjustment must be made with the machine turned off and with the electrical power supply disconnected. 

Look the Fig. 9

A

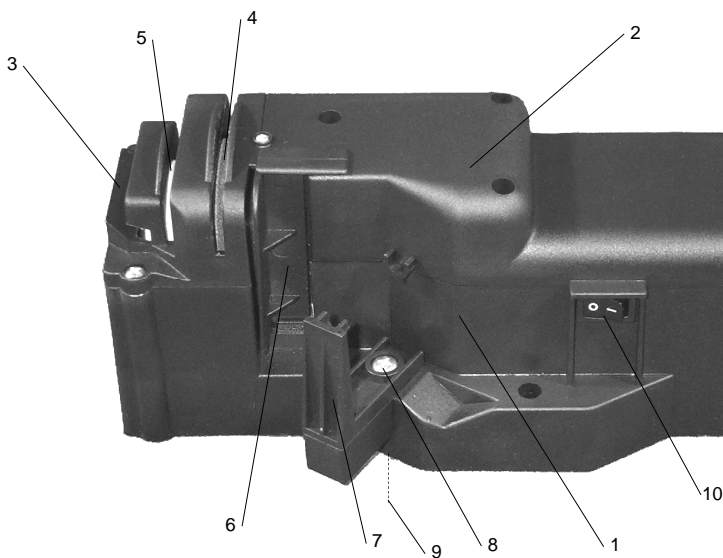

**N. Definition**

**Pcs.**

10) Switch

1

- 1) Base
- 2) Cover
- 3) Grinding wheels guard
- 4) Abrasive grind. 60mm.
- 5) Abrasive grind. 45mm.
- 6) Drill Bit guard
- 7) Support for "block brings drill bit"
- 8) Screw M5x10
- 9) Nut M5

1  
1  
1  
1  
1  
1  
1  
1  
1

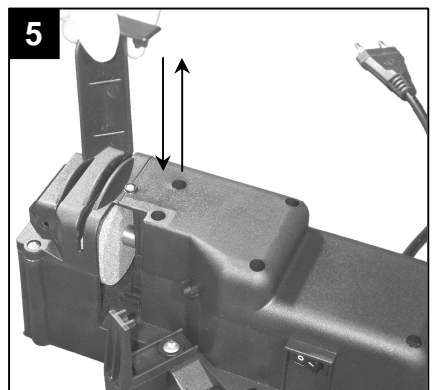
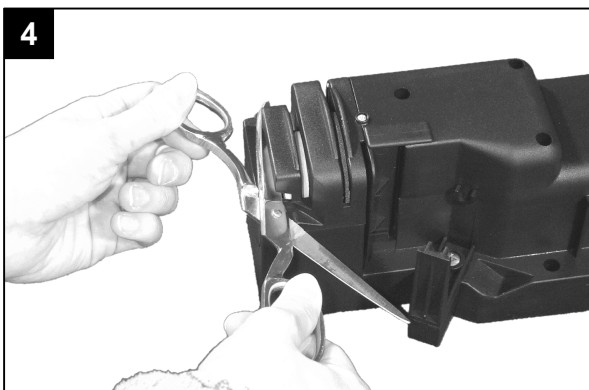
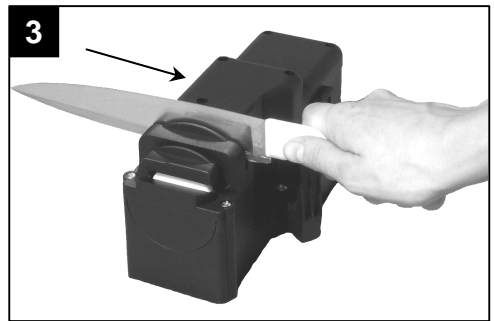
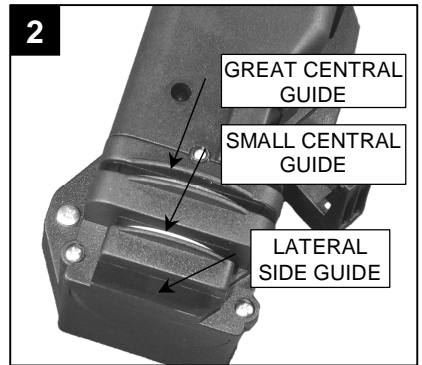
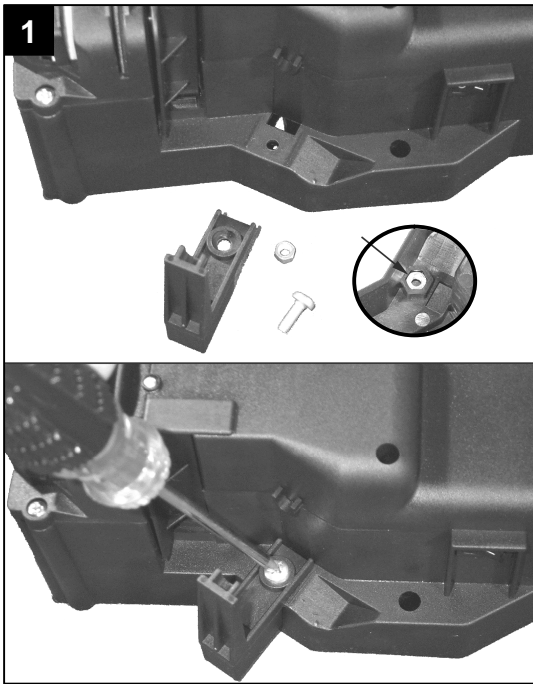

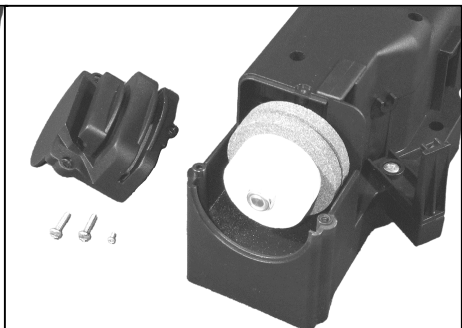
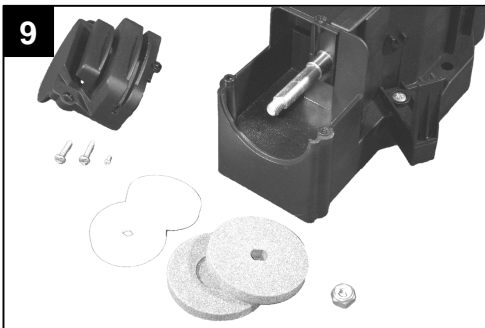
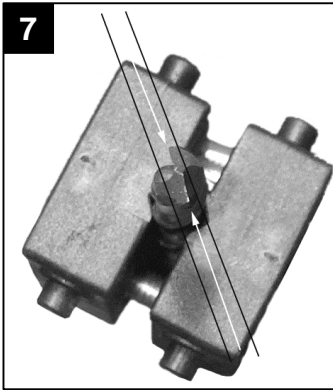
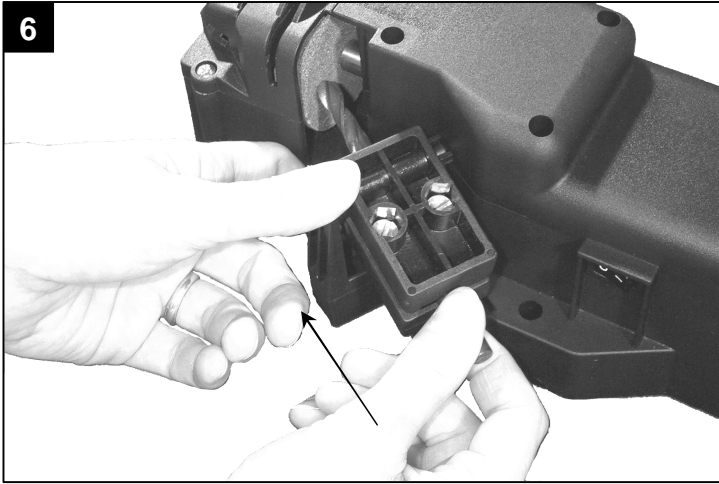

# DECLARATION OF CONFORMITY

We declare that the new machine:

**TYPE:** **MULTIFUNCTION ELECTRIC GRINDER**

**Model:** **AFF-MOT**

complies with the requirements of the directives:

- ☐ 98/37/CE (EC Directive machine)
- ☐ 73/23 CEE (EC Directive regarding low-voltage equipment)
- ☐ 89/336 CEE and subsequent, amendments and supplements (EC Directive regarding electromagnetic compatibility)

**01.12.2005**

**THE LEGAL REPRESENTATIVE**

